

FREE
furniture package or
£1,500* You choose!

MERIDIAN APARTMENTS

KINGFISHER PARK | BUNTINGFORD | HERTS



Computer generated image

AN OUTSTANDING COLLECTION OF TWO BEDROOM NEW BUILD HOMEBUY APARTMENTS





PRIME APARTMENTS CLOSE TO THE PRIME MERIDIAN

Meridian Apartments is an outstanding collection of two bedroom apartments available through the Government's New Build HomeBuy scheme (part-buy, part-rent). The apartments are contained within a smart new apartment building at Kingfisher Park, a prestigious development by renowned housebuilding company Barratt Homes.

Kingfisher Park lies approximately half a mile south east of Buntingford town centre. Considered one of Hertfordshire's more desirable places to live, Buntingford is an attractive market town nestling on the banks of the River Rib. The historic town centre boasts a wealth of listed medieval and Georgian buildings, and for many centuries served as a coaching stop on the main London to York road. The Prime Meridian, from which the apartments take their name, is located just to the east of the town.

Buntingford today is a bustling town with a strong sense of community. An abundance of local clubs and activities are on offer, from dance and drama to football and cricket. The town's biannual carnival is also a high profile event in the county's calendar.

Every day shopping needs are catered for by a small selection of shops which include a Budgen supermarket. A range of pubs, restaurants, cafes and a wine bar can also be found in the town centre. Stevenage and Bishops Stortford, approximately 11 miles away, offer a wider range of retail outlets, restaurants, bars and a multi-screen cinema.

Buntingford is surrounded by some of the most picturesque countryside north east Hertfordshire has to offer. From ancient woodlands and open green spaces to the banks of the beautiful River Rib there is plenty for lovers of nature and wildlife to enjoy.

MERIDIAN APARTMENTS

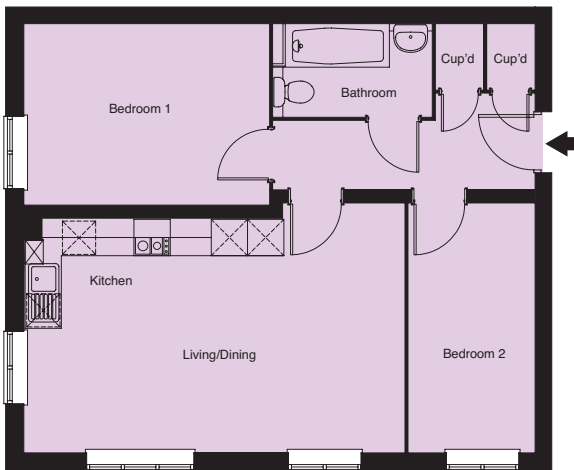
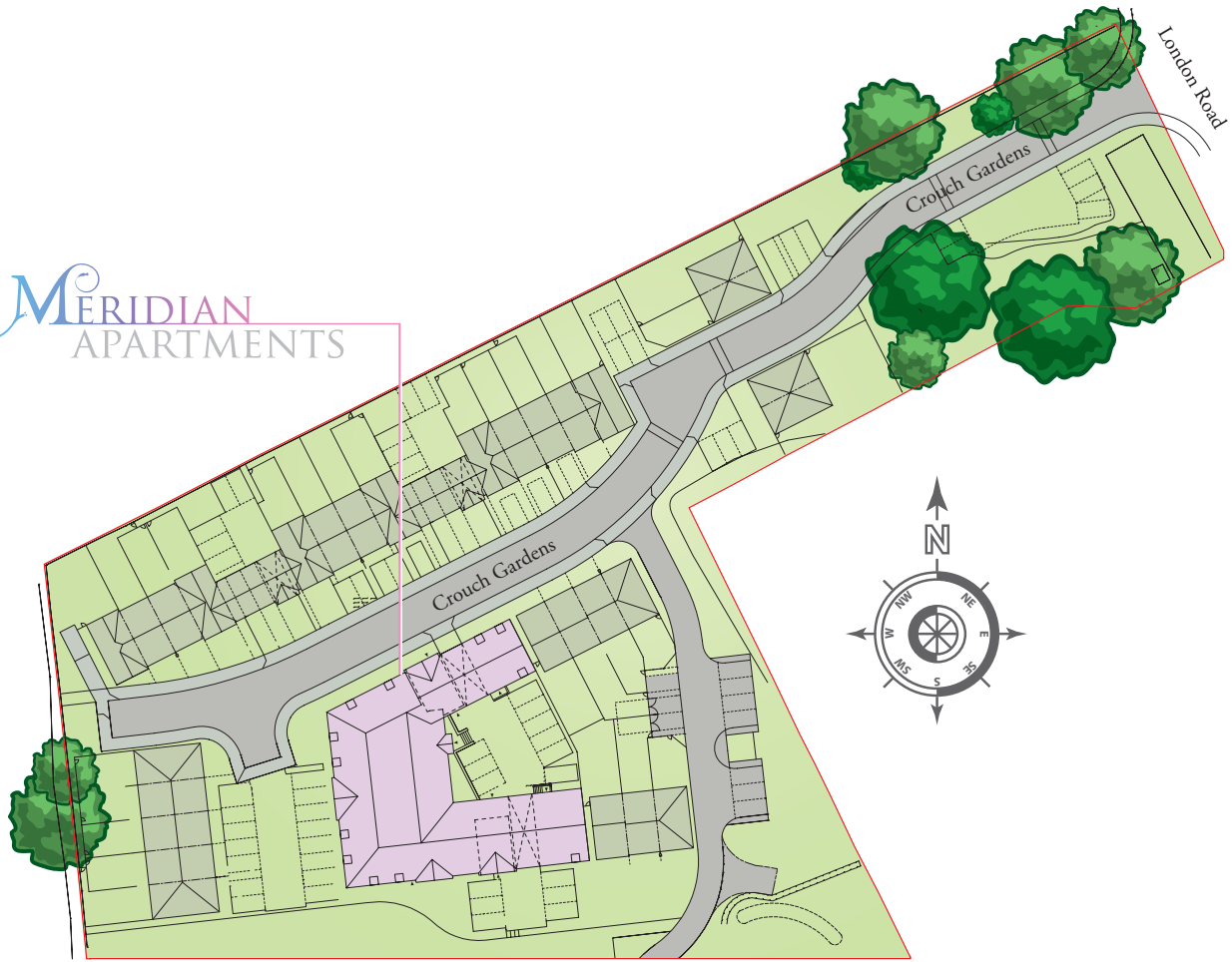

Apartment Type A4
APARTMENT 114
 Area: 59.3m² (638.3 sq ft)

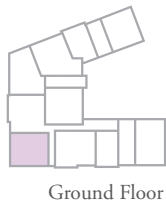

Apartment Type A9
APARTMENT 126
 Area: 57m² (613.4 sq ft)

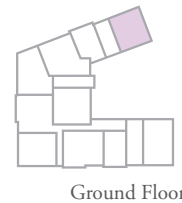

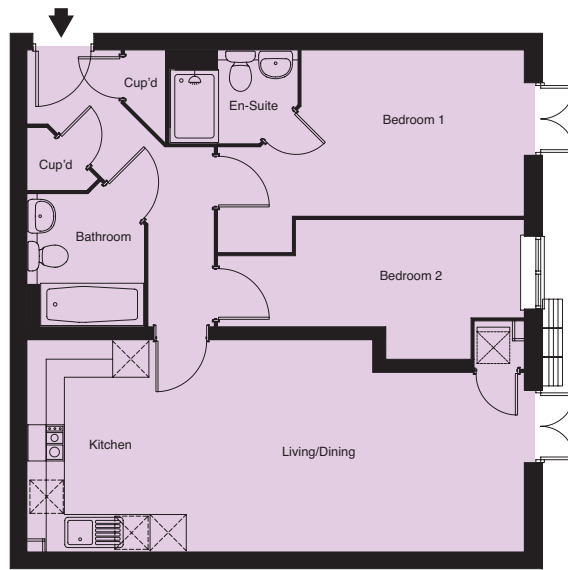

Apartment Type A10
 APARTMENTS
 127 / 130 / 135
 Area: 67.5m² (726.5 sq ft)

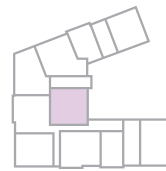

Ground, First and
 Second Floor

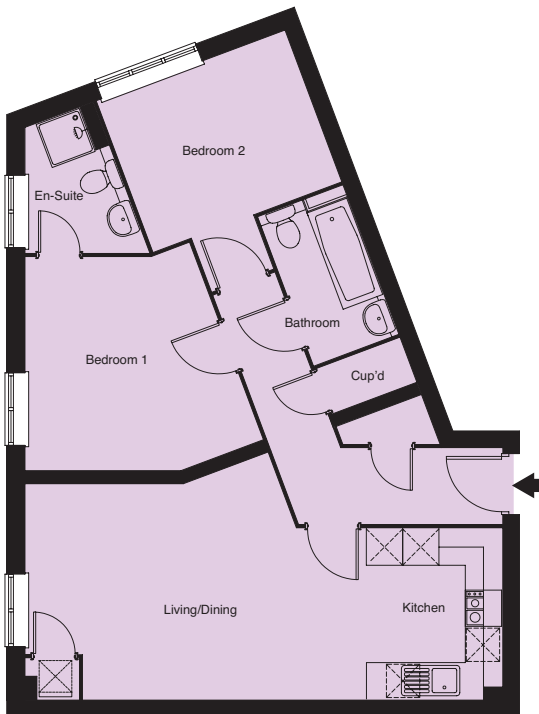

Apartment Type A6
 APARTMENTS
 128 / 131 / 136
 Area: 67.4m² (725.5 sq ft)

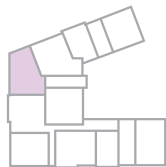

Ground, First and
 Second Floor



Apartment Type A7
 APARTMENT 129
 Area: 72.3m² (778.2 sq ft)

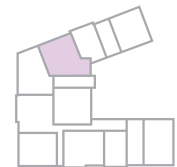

Ground Floor



Apartment Type A7A
APARTMENTS 132 / 137
 Area: 67.1m² (722.2 sq ft)

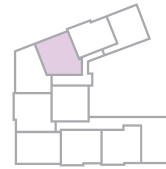

First & Second* Floor



Apartment Type A8
APARTMENTS 133 / 138**
 Area: 58.9m² (634 sq ft)

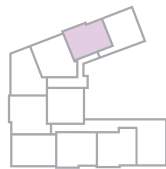

First & Second* Floor



Apartment Type A9A
APARTMENTS 134 / 139
 Area: 60.7m² (653.3 sq ft)



First & Second* Floor

* Please note that second floor apartments have sloping ceilings (2.19m to 2.39m) ** Apartment 138 has the boiler located in the linen cupboard

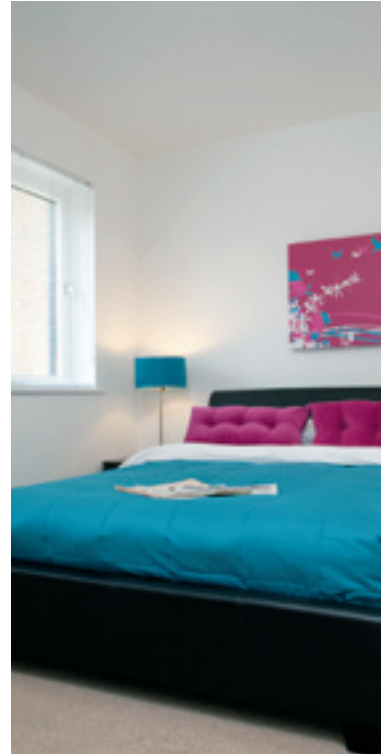

Images depict previous Network Housing Group developments

SPECIFICATION

Meridian Apartments offer a range of floor layouts intelligently designed to make the maximum use of the available space. Inside the accent is streamlined and sleek, as evidenced by the contemporary style designer kitchen and bathroom. Unusually for apartments offered through New Build HomeBuy, every kitchen comes complete with the full range of integrated appliances. Additionally, most apartments feature an en-suite to the master bedroom; all benefit from an allocated parking space.

KITCHEN

- Fully fitted contemporary cupboard units
- 1.5 bowl sink with mixer tap
- Built-in stainless steel electric oven and ceramic hob
- Extractor hood
- Integrated appliances: fridge/freezer, washer/dryer and dishwasher
- Chrome electrical sockets above worktop

BATHROOM & ENSUITE

- Contemporary white sanitaryware
- Grohe thermostatic bath shower mixer
- Ceramic wall tiling to selected areas
- Chrome heated towel rail
- Chrome shaver socket

SECURITY

- Entry phone system
- UPVC double glazed windows

GENERAL

- Ceramic floor tiling to kitchen, bathroom and en-suite
- Carpet to hall, lounge and bedrooms

HEATING AND ELECTRICAL

- Energy efficient gas boiler and wet radiator system
- Downlights to bathroom and ensuite
- Smoke detectors
- Carbon Monoxide detector
- Communal digital TV aerial and satellite dish

COMMUNAL AREA

- Renewable energy supplied by photovoltaic cells
- Allocated off-street parking

MERIDIAN APARTMENTS



ACCESS ALL AREAS

Buntingford is just 34 miles north of London via the A10, and 22 miles from Cambridge. Most of the county's major towns are also easily accessible: Stevenage and Bishop's Stortford are 11 miles away whilst the county town of Hertford is 13 miles away.

The A10 is just ¼ mile from Meridian Apartments, offering swift access to the M25 (20 miles away) and the rest of the motorway network. Fast train routes into the capital can be accessed from Stevenage – 40 minutes into London Kings Cross – and from Bishop's Stortford – 50 minutes into Liverpool Street.

Stansted Airport is just 17 miles east of Buntingford, offering a wide variety of international flight destinations.

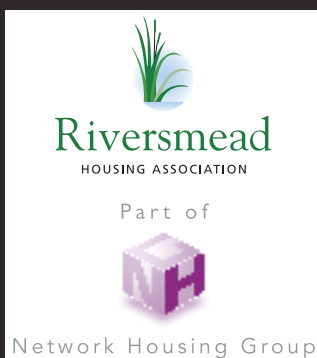

For further information please contact:



0845 130 1422
www.stagnellfox.co.uk

These brief particulars have been prepared and are intended as a guide to supplement an inspection or survey and do not form part of any offer or contract. Their accuracy is not guaranteed. They contain statements of opinion and in some instances we have relied on information supplied by others. The images and photographs contained in this brochure are not all of Meridian Apartments. This brochure includes photographs of the surrounding area and other Network Housing Group show apartments for illustrative purposes only. Design elements and specification details may change without further notice. You should verify the particulars on your visit to the site and the particulars do not obviate the need for a survey and all the appropriate enquiries. Accordingly, there shall be no liability as a result of any error or omission in the particulars or any information given. All information correct at time of print - November 2010. *Conditions apply.

Network Housing Group Limited. Registered office and correspondence address: Olympic Office Centre, 8 Fulton Road, Wembley, Middlesex HA9 0NU.
 A charitable Industrial & Provident Society No. 29543R. Registered provider no. 14373.